 **DANGER** 111 000 68

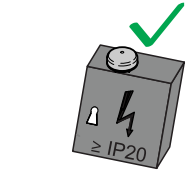





**D** Anschluss **ausschließlich** durch ausgebildete Elektro-Fachkräfte.  
**GB** Electrical connection is to be made by trained electrical specialists **only**.  
**F** Le branchement doit **uniquement** être effectué par des professionnels.  
**I** Il collegamento deve essere eseguito **solo** da elettricisti specializzati.  
**E** La conexión **sólo** debe ser realizada por electricistas debidamente formados.  
**PT** A ligação deve ser feita **exclusivamente** por profissional elétrico especializado.  
**NL** De aansluiting mag **enkel** gebeuren door erkende vakmensen.  
**CZ** Pøipojení smí **provádít** pouze kvalifikovaný personál.  
**PL** Podłączenie **wyłącznie** przez specjalistów-elektryków.  
**FI** Liittäminen kuuluu **ainoastaan** koulutettujen sähköalan ammattilaisten tehtäviin.  
**RUS** Подключение проводится только специалистом-электриком.  
**TR** Bağlantı **sadece** eğitimli elektrik teknisyenleri tarafından yapılmalıdır.  
**CN** 布线需由专业电工执行

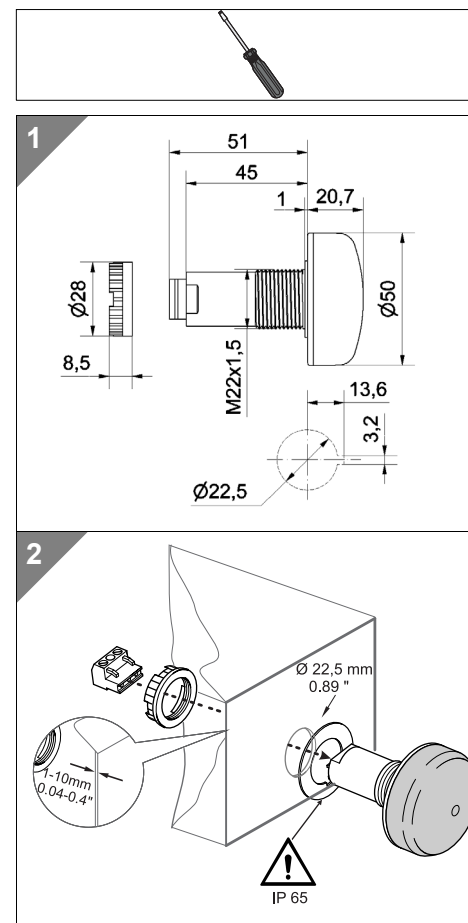

2800 Hz	80 dB(A) / 1m
111 000 55	24 V~, 25 mA
111 000 68	230 V~, 20 mA



 **DANGER**





0,26-0,3 Nm  
 2.3-2.7 lb·in

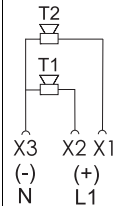

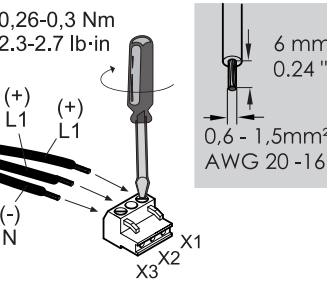

	X3	N (-)
	X2	L1 (+)
	X1	L1 (+)
230 V	X2 & X3	T1
	X1, X2 & X3	T2
24 V	X2 & X3	T1
	X1 & X3	T2

**4**  **WARNING**

